

domiLINE 80

domiLINE 80 Schlitteneinheit
domiLINE 80 slide unit

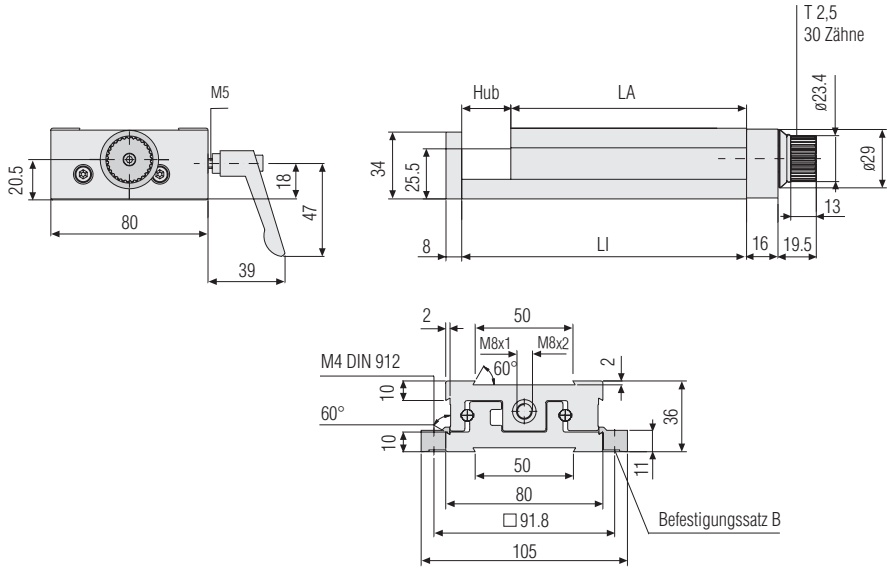

Befestigungssatz B
Fastening set B

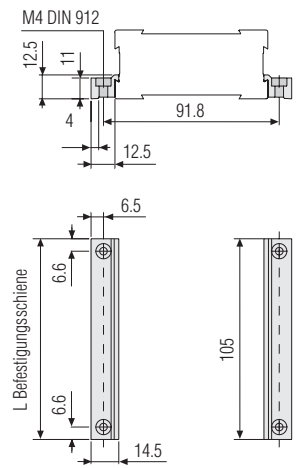

X-Y Verbindungssatz
X-Y connecting set

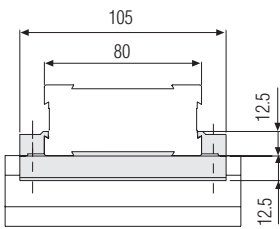

X-Z Verbindungssatz
X-Z connecting set

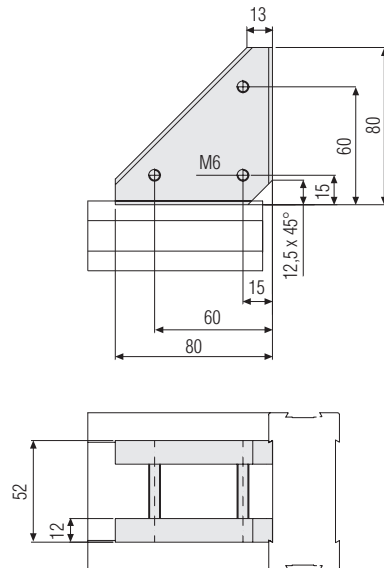

Dreheinheit
Rotational unit

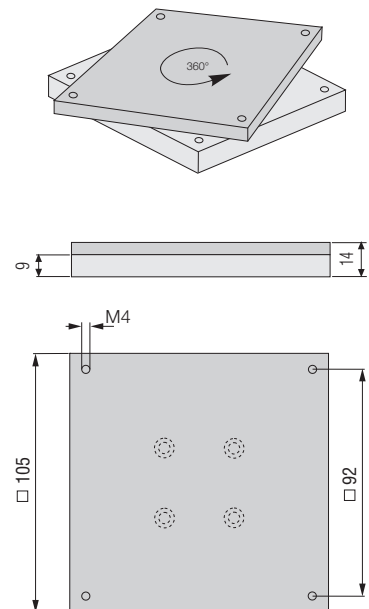

Standardeinheiten domiLINE 80 - Lagerware / Standard units domiLINE 80 - stock goods

B	LA	LI	Hub/Stroke	G	P	K	E	Gewicht/Weight	Art.-Nr./Art no.
80	120	145	25	G	1	-	E	1000 g	1007820
80	120	170	50	G	1	-	E	1100 g	1004058
80	120	195	75	G	1	-	E	1200 g	1007821
80	120	220	100	G	1	-	E	1300 g	1007822

Zubehör / Accessories

Bezeichnung / Designation	Art.-Nr./Art no.
Klemmhebel / Clamping lever	1009543
Befestigungssatz, Standardlänge 105 mm / Fastening set, standard length 105 mm	319220
Montageplatte komplett, Länge 105 mm / Mounting plate complete, length 105 mm	319221
X-Y Verbindungssatz / X-Y connecting set	319222
X-Z Verbindungssatz / X-Z connecting set	319223
Zusatzplatte / Additional plate	319225
T-Nutenplatte / T-groove plate	319226
Befestigungssatz, Sonderlänge in mm / Fastening set, special length in mm	319227
Montageplatte, Sonderlänge in mm / Mounting plate, special length in mm	319228
Befestigungssatz mit Gewinde L = 105 mm / Fastening set, with thread L = 105 mm	319229
Befestigungssatz mit Gewinde Sonderlänge / Fastening set with thread special length	1006147
Befestigungsbohrung / Fastening hole	319201
Dreheinheit 80 komplett mit Befestigungssatz / Rotary unit 80, complete	319230
Digital-Anzeige / Digital display	-
Handrad / Hand wheel	-
Endschalter Öffner / Limit switch, NO contact	025165
Endschalter Schließer / Limit switch, NC contact	726744
Motorflansch inkl. Kupplung / Motor flange including coupling	319203

Montageplatte **M**
Mounting plate **M**

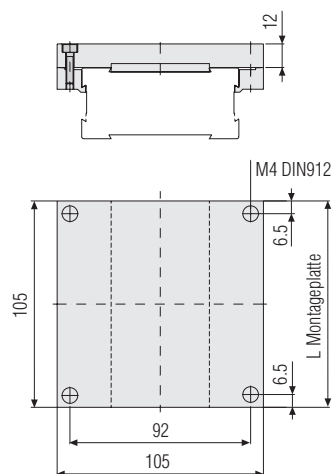

B = Breite mm
LA = Länge Außenschlitten
LI = Länge Innenschlitten
Hub = in mm
G = Gleitführung
P = Spindelsteigung
E = Endplatte

B = width mm
LA = length, outer slide
LI = length, inner slide
Stroke = in mm
G = slideway
P = spindle pitch
E = end plate

Zulässige Belastungen domiLINE 80
Maximum loads domiLINE 80

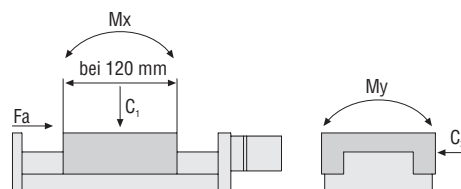

Fa = 150 N C₂ = 365 N
C₁ = 500 N Mx = 8 Nm
My = 10 Nm Mz = 6 Nm