

General specifications	KR810	KR1205
Reach (mm)	850	1200
Payload (kg)	10	5
Weight (kg)	24	25
Joint Speed (deg/sec)	225	225
Joint Ranges (deg)	J2 and J4: -70°/+180° J1, J3, J5, J6 and J7: ±360°	
Brakes on joints	Yes	Yes
Absolute encoders on joints	Yes	Yes
Repeatability (mm)	+/- 0.1	+/- 0.1
Degrees of freedom	7	7
Foot print (mm)	130x130	130x130
Operating temperature (C°)	0-45	0-45
Body material	Anodized aluminum	
Protection rating	IP54	IP54

Controller	KR Controller KR810/KR1205
Digital outputs 24V (pcs)	8
Relay outputs (pcs)	4
Digital inputs 3-30V (pcs)	16
Analogue I/O 0-10V (pcs)	2/2
Analogue I/O 4-20mA (pcs)	2/2

Power	KR810/KR1205
Power consumption (with max. load; W)	400-600
Supply Voltage (VAC)	100-120 or 200-240
Supply Current (A)	16
Supply frequency (Hz)	50/60
Max speed (mm/s)	1200/1800
Absolute encoders on joints	Yes
Sound level (dB) Below	70

Robot frames, kinematics and mechanical interfaces

KR810/KR1205

Tool head with connections

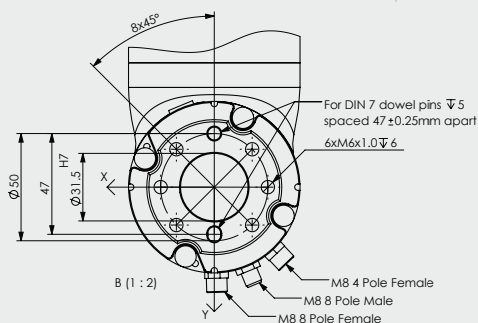

KR810/KR1205

Based plate dimensions

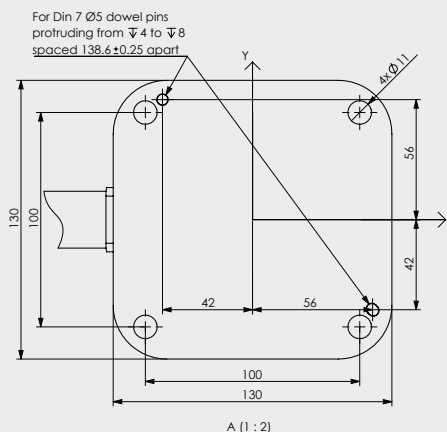

KR810

Dimensions

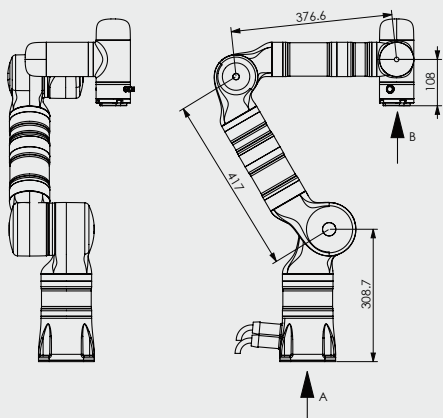

KR1205

Dimensions

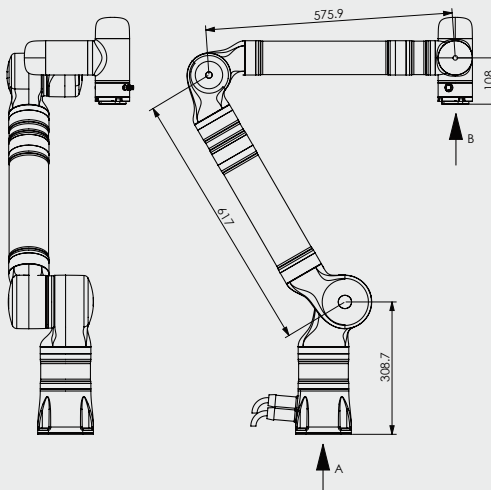

Kassow Robots: Product Family

Reach/Payload

KR810 850 mm/10 kg

KR1205 1200 mm/5 kg

KR1410 1400 mm/10 kg

KR1805 1800 mm/5 kg

You will find the technical data of the two other cobots **KR1410** and **KR1805** in an extra data sheet.

(Last revised 03/2020)



Contact

Kassow Robots
 Oliefabriksvej 57
 2770 Kastrup, Denmark
 +45 20 24 09 95
sales@kassowrobots.com
www.kassowrobots.com